

WEDA PUMP

World leader in professional submersible drainage pumps

SPAREPARTS CATALOGUE

RL 6090



SPARE PARTS CATALOGUE

RESERVDLSTÄLLNING

Följande uppgifter ska lämnas vid beställning av reservdelar för att undvika leveransfel :

1. Maskintyp.
2. Vältens serinumner.
3. Antal av önskad reservdel.
4. Reserdelens artikelnummer.
5. Reservedelens benämning.
6. Måttuppgifter vid beställning av metervara.

ERSATZTEILBESTELLUNG

Zur Vermeidung von Fehllieferungen sind bei der Bestellung von Ersatzteilen folgende Angaben zu machen :

1. Mashinentyp.
2. Herstellungsnummer.
3. Bestellmenge. (Quantity)
4. Ersatzteilbenennung. (Part N°)
5. Ersatzteilbenennung. (Description)
6. Massangaben bei Bestellung von Meterware.

PEDIDO DE RECAMBIOS

Para evitar errores en las entregas, deberá indicarse los siguientes datos al hacer un pedido de recambios :

1. Tipo de máquina.
2. Número de serie.
3. Cantidad de piezas deseadas. (Quantity)
4. Número de artículo de la pieza de recambio. (Part N°)
5. Denominación de la pieza. (Description)
6. Indíquese la medida al solicitar un artículo que se expide por metros.

RESERVEDELEN BESTELLEN

Om foutieve leveringen te voorkomen, vermeld bij uw bestelling de volgende informatie:

1. Type van de machine (pomp)
2. Machine serienummer
3. Aantal benodigd
4. Onderdeel nummer(s)
5. Onderdeel omschrijving
6. Afmetingen indien per lengte besteld wordt.

ORDERING SPARE PARTS

To avoid errors in delivery, please give the following information when ordering spare parts :

1. Type of machine.
2. Machine serial number.
3. Quantity required.
4. Part number.
5. Parts description.
6. Dimensions when ordering per length.

ORDINI DI RICAMBI

Per evitare errori nelle consegne di ricambi, Vi preghiamo di comunicarci le seguenti informazioni al momento dell'ordinazione :

1. Tipo di macchina.
2. Numero di serie della macchina.
3. Quantit  dei pezzi desiderati. (Quantity)
4. Numero di codice del pezzo. (Part N°)
5. Descrizione del pezzo di ricambio. (Description)
6. Misura, in caso di ordine per metro.

COMMANDE DE PIECES DE RECHANGE

Les indications suivantes doivent  tre fournies lors de la commande de pi ces de rechange, afin d' viter toute erreur de livraison :

1. Type de machine.
2. Num ro de s rie.
3. Quantit  d sir e de pi ce de rechange. (Quantity)
4. Num ro de la pi ce de rechange. (Part N°)
5. Description de la pi ce de rechange. (Description)
6. Longueur en cas de commande par m tre.

SPARE PARTS

Note : To place spare parts order, use :

- The serial number of the machine
- The description and part number;

RL6090									
Ref	Designation	P/N	Qty		Ref	Designation	P/N	Qty	
			LH	HH				LH	HH
1	Handle complete	W292062	1	1	60	Stop washer	W294038	1	1
2	Rivet	W65430	4	4	61	Nut	W294037	1	1
3	Data plate	W743583	1	1	62	Bearing bracket	W291021	1	1
4	Sealing	W209428	1	1	63	O-ring	W65031	1	1
5	Washer	W209731	1	1	64	Circlip	W50679	3	3
6	Sealing	W209429	1	1	65	Seal holder	W294109	1	1
7	Piston direct start	W209647	1	1	66	Upper seal	W294107	1	1
	Piston Y/D start	W274084	1	1	67	Holder *	W294106	1	1
8	Spring	W209434	1	1		Holder **	W743506	1	1
9	Guide	W209435	1	1	68	O-ring	W294105	2	2
10	Nut	W84211	6	6	69	Distance ring *	W294112	1	1
11	Cover 380-500V	W292064	1	1		Distance ring **	W743531	1	1
	Cover for NVB	W292213	1	1	70	O-ring	W65112	2	2
12	Nut	W84210	7	7	71	Bearing	W294111	2	2
13	Washer	W209438	1	1		Bearing cpl Incl pos 69,71	W294110	1	1
14	Screw	W209501	1	1	72	Bearing bracket	W292055	1	1
15	O-ring	W65134	3	3	73	Washer	W294171	7	7
16	O-ring	W65251	1	1	74	Lower seal	W294108	1	1
17	Plug	W294127	2	2	75	Oil bag Incl. pos 76	W293088	1	1
18	Sleeve 380-500V	W294164	2	2	76	Seal clamp	W294226	1	1
	Sleeve220V Y/D	W294125	2	2	77	Ring for oil bag	W294103	1	1
19	Screw	W78698	1	1	79	Impeller 50Hz	W292043	1	-
20	Thrust collar	W294126	2	2		Impeller 60Hz	W292044	1	-
21	Nut	W84213	2	2	80	Washer	W294036	1	1
22	Stud bolt	W69656	6	2	81	Impeller nut	W294035	1	1
23	Top bracket 380-415V Y/D direct start	W291020	1	1	82	Protective housing	W292065	1	1
	Top bracket 380-415VY/D start	W292204	1	1	83	Diffusor	W291012	1	-
	Top bracket 230V for external protection	W292312	1	1	84	O-ring	W65174	1	1
	Top bracket 230V	W293097	1	1	85	O-ring	W65137	1	1
	Top bracket 380-415V external Y/D start without thermal protection	W730011	1	1	86	Diffusor holder	W293080	1	1
24	O-ring	W65033	1	1	87	Washer	W51181	6	6
25	O-ring	W65177	2	2	89	Washer	W51176	8	8
26	Stud bolt	W294123	2	2		Trim washer	W294124	20	20
27	O-ring	W65143	1	1	90	Diffusor centre	W291014	1	-
28	Inner casing	W291025	1	1	91	Spring washer	W58915	10	10
29	Stud bolt	W293087	4	4	92	Strainer	W294102	1	1
30	Stator See page 12	-	-	-	93	Base plate	W293091	1	1
31	Discharge 4" for hose	W203564	1	1	94	Screw	W76343	6	6
	Discharge 4" BSP thread	W203482	1	1	95	Impeller 50 Hz	W292045	-	1
	Discharge 4" NPT thread	W203572	1	1		Impeller 60Hz	W292046	-	1
32	Washer	W51170	6	6	96	Diffusor	W291016	-	1
33	Stud bolt	W69640	6	6	97	Spacer	W294191	-	4
34	O-ring	W743466	1	1	98	Stud bolt	W69656	-	4
35	Jointing bracket Incl pos 12,32,33,36.	W282059	1	1	99	Diffusor centre	W291018	-	1

RL6090 (continued)

Ref	Designation	P/N	Qty		Ref	Designation	P/N	Qty	
			LH	HH				LH	HH
36	Discharge packing	W284058	1	1	100	Electrode	W208106	1	-
37	Discharge 6" for hose	W283166	1	1	101	Washer	W209673	2	-
	Discharge 6" BSP thread	W283176	1	1	102	Nut	W84205	4	-
	Discharge 6" NPT thread	W283168	1	1	103	Flat pin	W50331	2	-
38	Cable inlet cpl .4x10mm ² 415-550V Y/D start incl. pos 44,49 .	W284103	1	1	104	Bracket	W209672	1	-
	Cable inlet cpl .4x16mm ² 400V incl. pos 44,49 .	W284104	1	1	105	Wiring diagram	W209865	1	-
	Cable inlet cpl .4x25mm ² 230V incl. pos 44,49 .	W209580	1	1	106	Short circuit	W209674	1	-
39	Cable 4x10mm ² 415-550V direct start	W283105	1	1	107	Electronic unit NVB 400V 50Hz	W209805	1	-
	Cable 4x10mm ² 400V Y/Dstart 415V Y/D start	W283105	2	2		Electronic unit NVB 440V 60Hz	W367186	1	-
	Cable 4x16mm ² 400V direct start	W284108	1	1		Electronic unit NVB 220V 50Hz	W367192	1	-
	Cable 4x16mm ² 400V Y/D start	W284108	1	1		Electronic unit NVB 240V 60Hz	W367193	1	-
	Cable 4x25mm ² 230V+230/400V	W208093	1	1		Electronic unit NVB 500V 50Hz	W209930	1	1
40	Circlip	W50525	1	1	108	Time relay 220-500V	W743509	1	1
41	Bearing	W61003	1	1	109	Terminal block 25mm ²	W209874	1	1
42	Cable sleeve 4x10mm ²	W284110	1	1	110	Time relay Y9a 400V	W209783	1	1
	Cable sleeve 4x16mm ²	W284100	1	1	111	Y/D Start cpl 400V	W292069	1	1
	Cable sleeve 4x25mm ²	W743583	1	1	113	Over current relay	W299593	1	1
43	Rotor	W292053	1	1	114	Bracket	W292061	1	1
50	O-ring	W65140	1	1	115	Contactora See page 12	-	-	-
51	O-ring	W65006	2	2	116	Coil See page 12	-	-	-
52	Seal unit cpl	W292054	1	1	117	Over current relay 220/440V60Hz	W294155	1	1
53	Oil plug	W274084	2	2		Over current relay 500V 50Hz	W743517	1	1
54	Screw	W75711	11	11		Over current relay 230/400V 50Hz 440/500V60Hz	W743549	1	1
55	Wear plate	W291010	1	1	118	Short circuit	W209928	1	1
56	Nut	W84213	8	8	119	Bracket	W214871	1	1
57	Distance sleeve	W294041	1	1	120	Wiring diagram	W740049	1	1
58	Connection	W294039	1	1		Wiring diagram	W740276	1	1
59	Trim washer	W294040	10	10		Wiring diagram	W740277	1	1
					122	Oil 5,2 l	W60015	1	1

* Pumps with manufacturing N° below 1971 . ** Pumps with manufacturing N° above 2000 .

STATOR and CONTACTOR Part Numbers

Power supply	Stator	Contactora complete	Coil for contactora	Stator Unit (28 + 30)
380-400V - 3 - 50Hz	W294139	W208125	W209771	W294149
415V - 3 - 50Hz	W294140	W208126	W209772	W294169
440V - 3 - 60Hz	W294139	W208125	W209771	W294149
500V - 3 - 50Hz	W294154	W208127	W209773	W294170

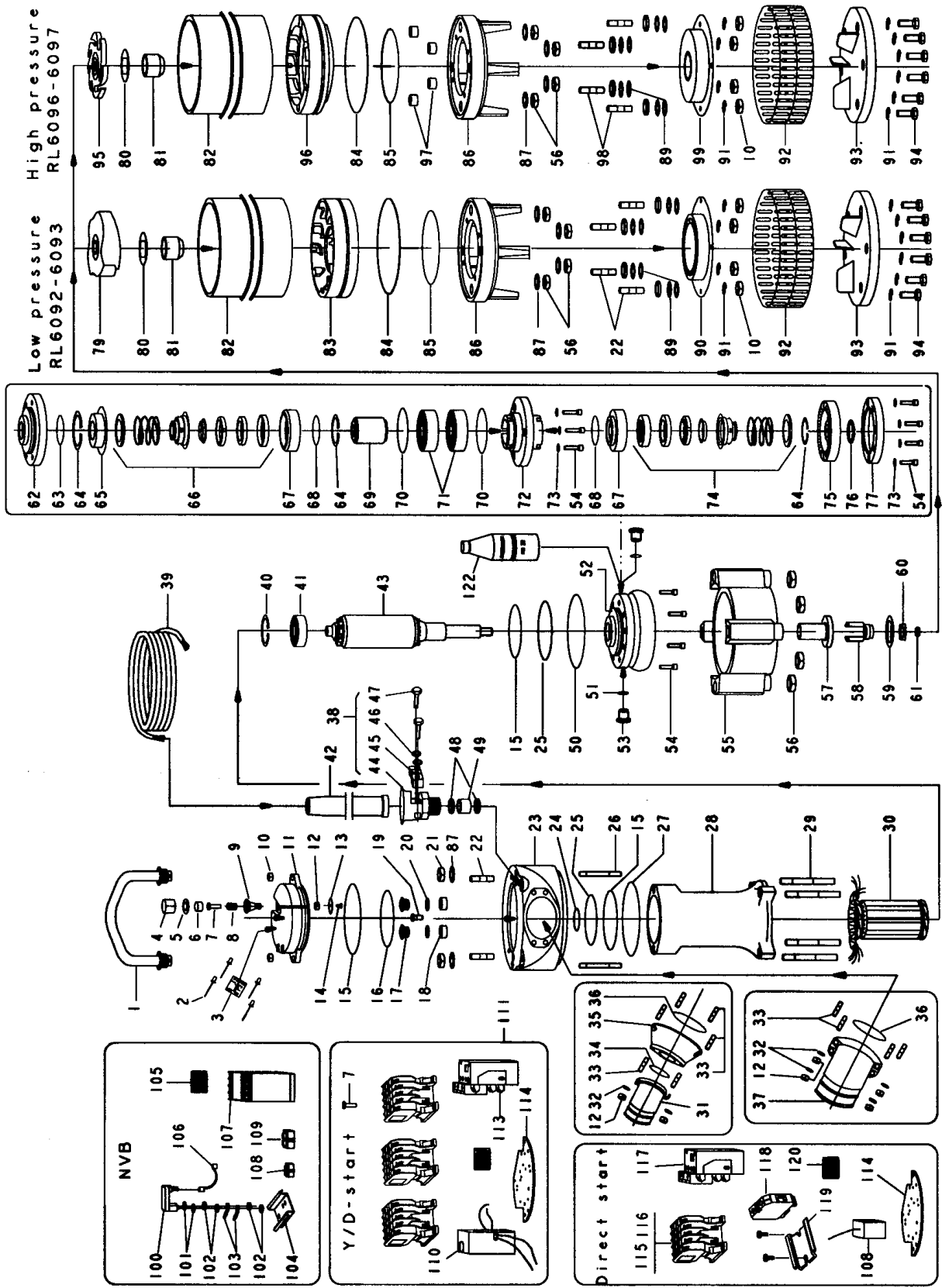

WEDA PUMP

World leader in professional submersible drainage pumps

page left intentionally blank for your convenience.



Delta Pompen B.V.

Rigaweg 17
9723 TE Groningen
The Netherlands
Tel.: +31 (0)50-2072380

E-mail: info@wedapump.com
Internet: <http://www.wedapump.com>

SERVICE AND GUARANTEE.

WEDAPUMP.COM is represented worldwide by a well-established service organization. Contact your local WEDAPUMP sales office if you require more information about servicing. Or left mentioned address.

wedapump.com reserves the right to change specifications without notice